

- Key**
- Development Boundary
 - Solar PV Array
 - Access Track
 - Construction Compound
 - Transformer
 - Substation
 - Security Fencing
 - Existing Vegetation

Drawn By: Jamie McGhee
 Address: Wright Business Centre
 1 Lonmay Road
 Glasgow
 G33 4EL

Ver.	Date	Comments
B	23/06/2021	Amendment to design
A	22/04/2021	



Project: Penpergwm Solar Farm
Client: Renewable Connection
Drawing: Indicative Infrastructure Layout (Overall)

Project No.: NEO00668
Drawing No.: NEO00668_0571_B DRAFT
Drawn: JM **Checked:** MM **Approved:** PN
Scale: 1:2,500 @ A1 **Revision:**
Date: 23 June 2021 **B**

© Neo Environmental Limited unless otherwise stated.
 Ordnance Survey © Crown Copyright 2021. All rights reserved. Licence number 100022432
 Do not scale from drawing - use dimensioned figures only



- Key**
- Development Boundary
 - Solar PV Array
 - Access Track
 - Transformer
 - ⚡ Substation
 - Security Fencing
 - 🌳 Existing Vegetation

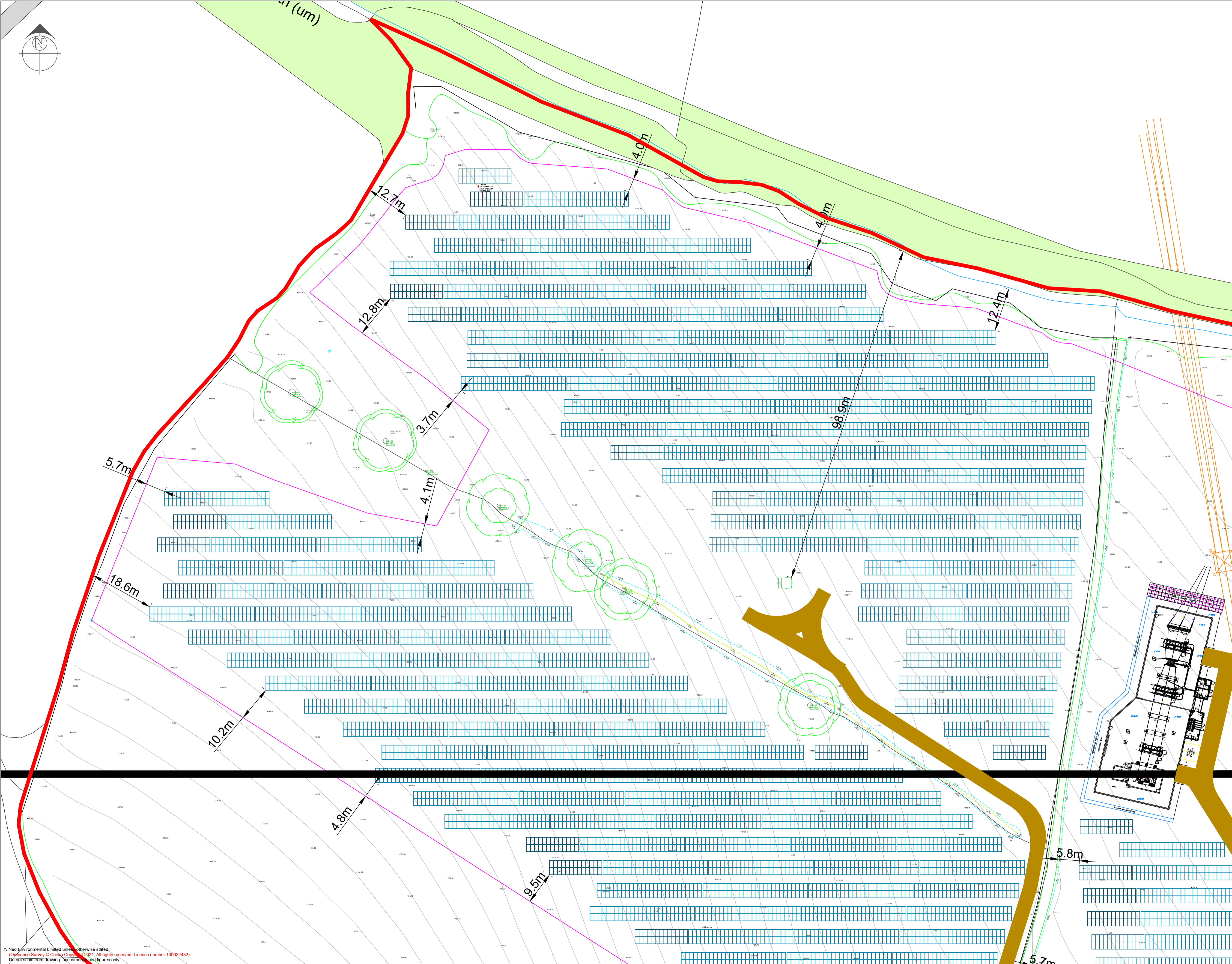

Drawn By: Jamie McGhee
 Address: Wright Business Centre
 1 Lonmay Road
 Glasgow
 G33 4EL

Ver.	Date	Comments



Project: Penpergwm Solar Farm
Client: Renewable Connection
Drawing: Indicative Infrastructure Layout (Sheet 2)
Project No.: NEO00668
Drawing No.: NEO00668_0581_A DRAFT
Drawn: JM **Checked:** MM **Approved:** PN
Scale: 1:500 @ A1 **Revision:**
Date: 22 April 2021 **A**

© Neo Environmental Limited unless otherwise stated.
 Compliance Survey © Crobie Copyright 2021. All rights reserved. Licence number 100022432
 Do not scale from drawing: use dimensioned figures only

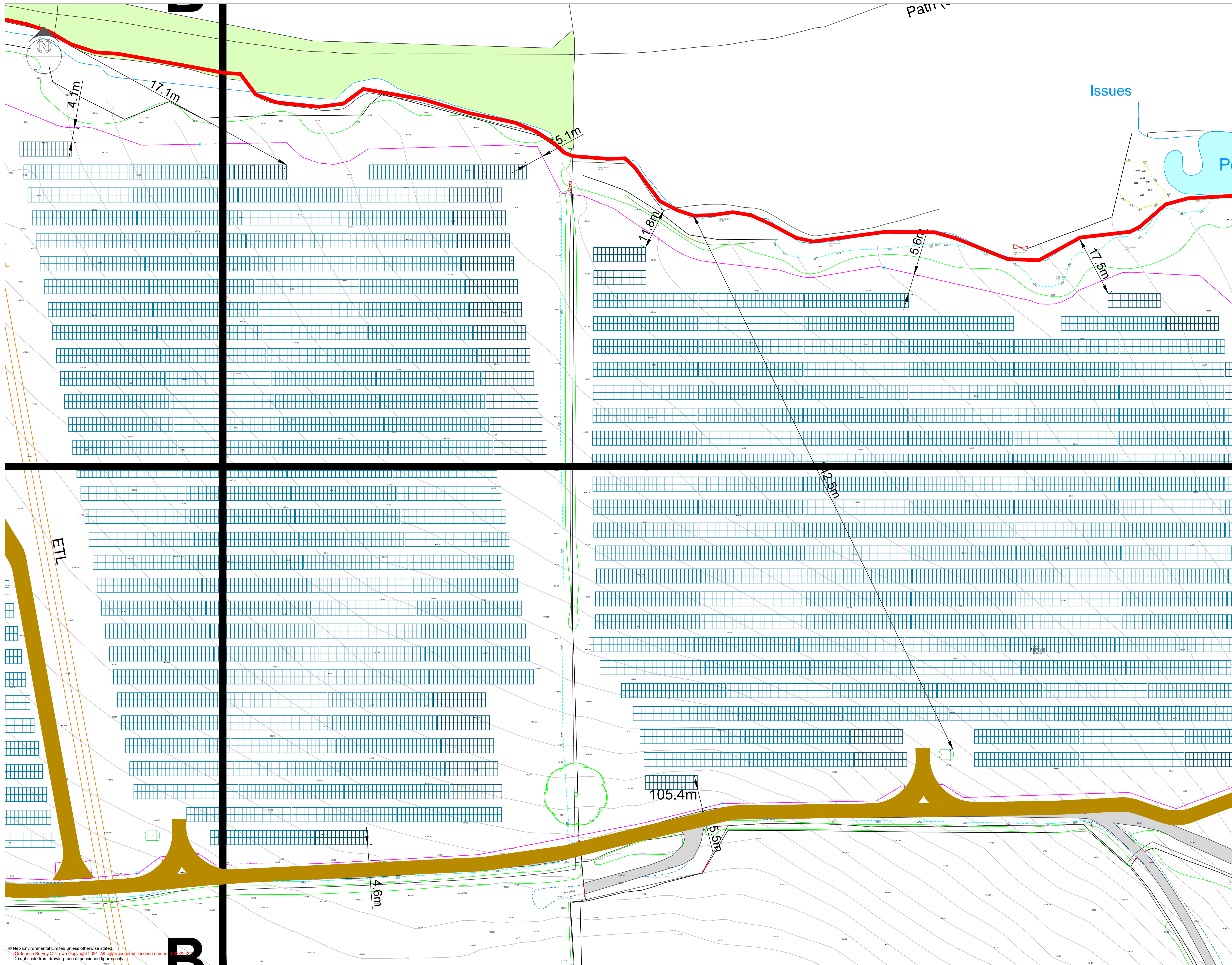

- Key**
- Development Boundary
 - Solar PV Array
 - Access Track
 - Transformer
 - Security Fencing
 - Existing Vegetation

Drawn By: Jamie McGhee
 Address: Wright Business Centre
 1 Lonmay Road
 Glasgow
 G33 4EL

Ver.	Date	Comments
A	22/04/2021	

neo
 ENVIRONMENTAL
 Warrington Office: T: 01925 661 716 E: info@neo-environmental.co.uk
 Glasgow Office: T: 0141 773 8262 E: info@neo-environmental.co.uk
 Naas Office: T: 00353 (0)45 844250 E: info@neo-environmental.ie
 Ballymena Office: T: 0282 565 0413 E: info@neo-environmental.co.uk

Project: Penpergwm Solar Farm
Client: Renewable Connection
Drawing: Indicative Infrastructure Layout (Sheet 3)

Project No.: NEO00668
Drawing No.: NEO00668_059I_A DRAFT
Drawn: JM **Checked:** MM **Approved:** PN
Scale: 1:500 @ A1 **Revision:**
Date: 22 April 2021 **A**

© Neo Environmental Limited unless otherwise stated.
 Ordnance Survey © Crown Copyright 2021. All rights reserved. Licence number 100022197
 Do not scale from drawing - use dimensioned figures only

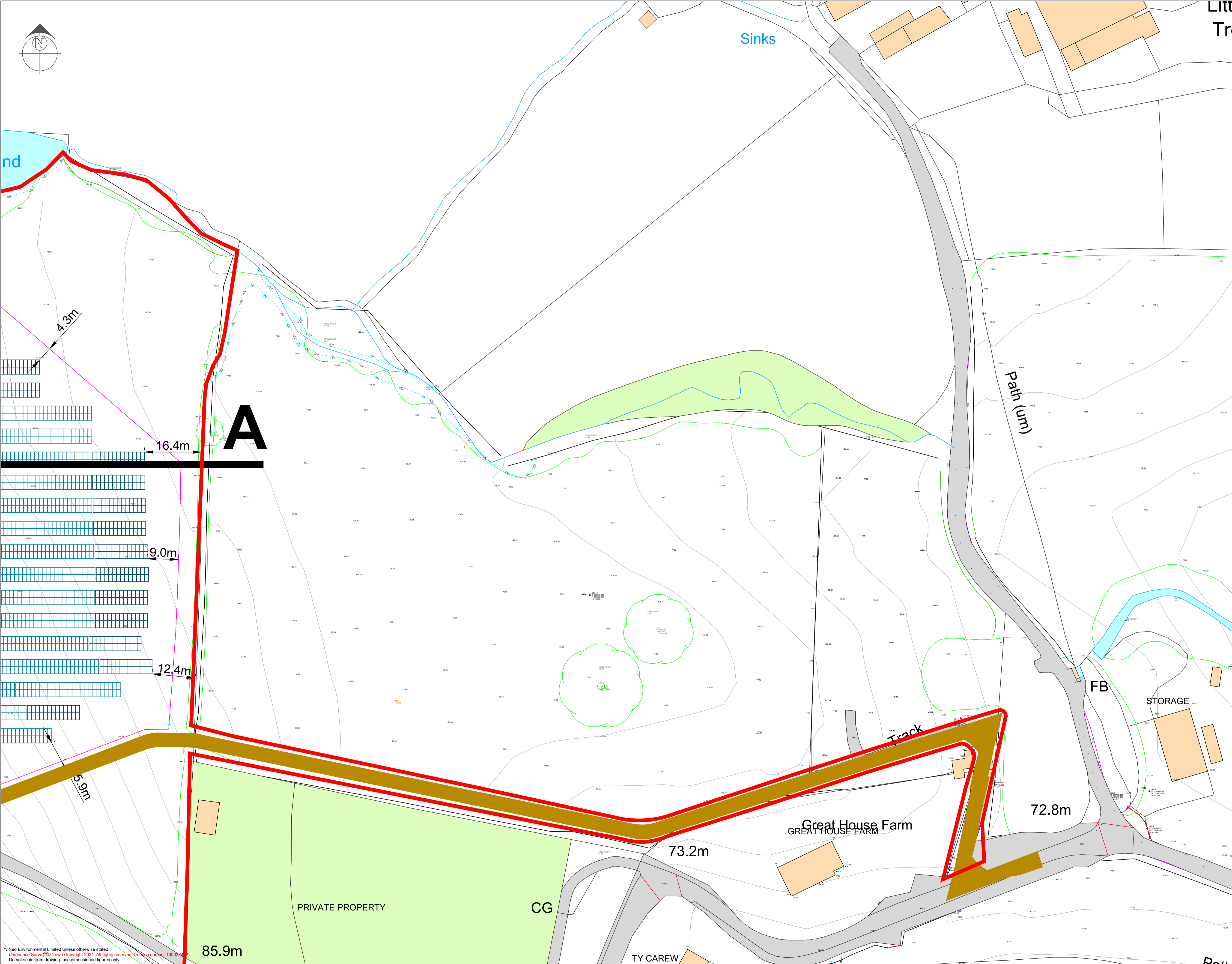

- Key
- Development Boundary
 - Solar PV Array
 - Access Track
 - Security Fencing
 - Existing Vegetation

Drawn By: Jamie McGhee
 Address: Wright Business Centre
 1 Lonmay Road
 Glasgow
 G33 4EL

Ver.	Date	Comments



Glasgow Office: T: 0141 773 6262 E: info@neo-environmental.co.uk
 Naas Office: T: 00353 (0)45 844250 E: info@neo-environmental.ie
 Ballymena Office: T: 0282 565 0413 E: info@neo-environmental.co.uk

Project: Penpergwm Solar Farm
 Client: Renewable Connection
 Drawing: Indicative Infrastructure Layout (Sheet 4)

Project No.: NEO00668
 Drawing No.: NEO00668_060I_A DRAFT
 Drawn: JM Checked: MM Approved: PN
 Scale: 1:500 @ A1 Revision:
 Date: 22 April 2021 A

© Neo Environmental Limited unless otherwise stated.
 Ordnance Survey © Crown Copyright 2021. All rights reserved. Licence number 100026429
 Do not scale from drawing - use dimensioned figures only

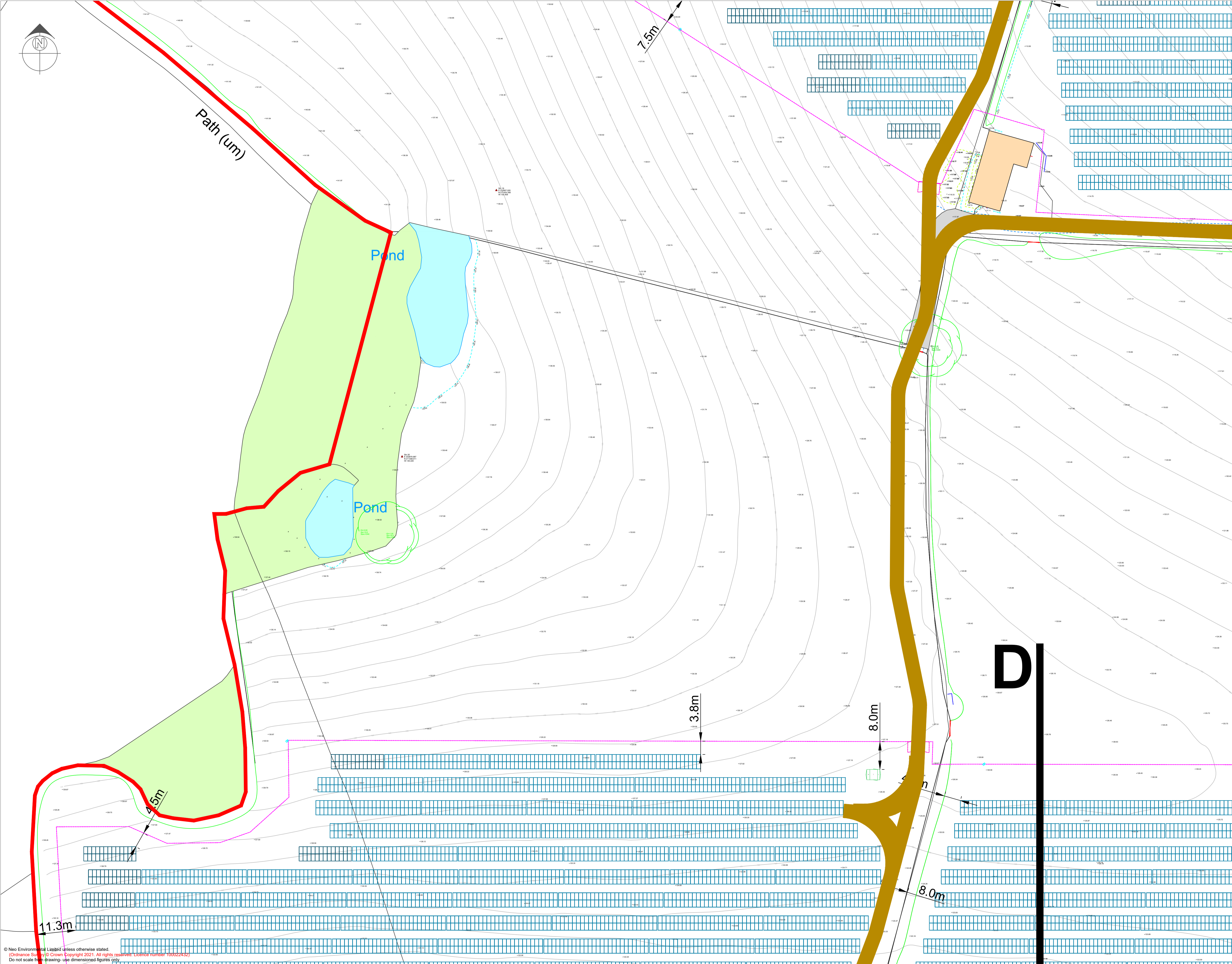

- Key**
- Development Boundary
 - Solar PV Array
 - Access Track
 - Transformer
 - Security Fencing
 - ⊗ Existing Vegetation

Drawn By: Jamie McGhee
 Address: Wright Business Centre
 1 Lonmay Road
 Glasgow
 G33 4EL

Ver.	Date	Comments

A 22/04/2021



Warrington Office: T: 01925 661 716 E: info@neo-environmental.co.uk

Glasgow Office: T: 0141 773 6262 E: info@neo-environmental.co.uk
 Naas Office: T: 00353 (0)45 844250 E: info@neo-environmental.ie
 Ballymena Office: T: 0282 565 0413 E: info@neo-environmental.co.uk

Project: Penpergwm Solar Farm
Client: Renewable Connection
Drawing: Indicative Infrastructure Layout (Sheet 5)

Project No.: NEO00668
Drawing No.: NEO00668_0611_A DRAFT
Drawn: JM **Checked:** MM **Approved:** PN

Scale: 1:500 @ A1 **Revision:**
Date: 22 April 2021 **A**

© Neo Environmental Limited unless otherwise stated.
 Ordnance Survey © Crown Copyright 2021. All rights reserved. Licence number 100022432
 Do not scale from drawing - use dimensioned figures only.

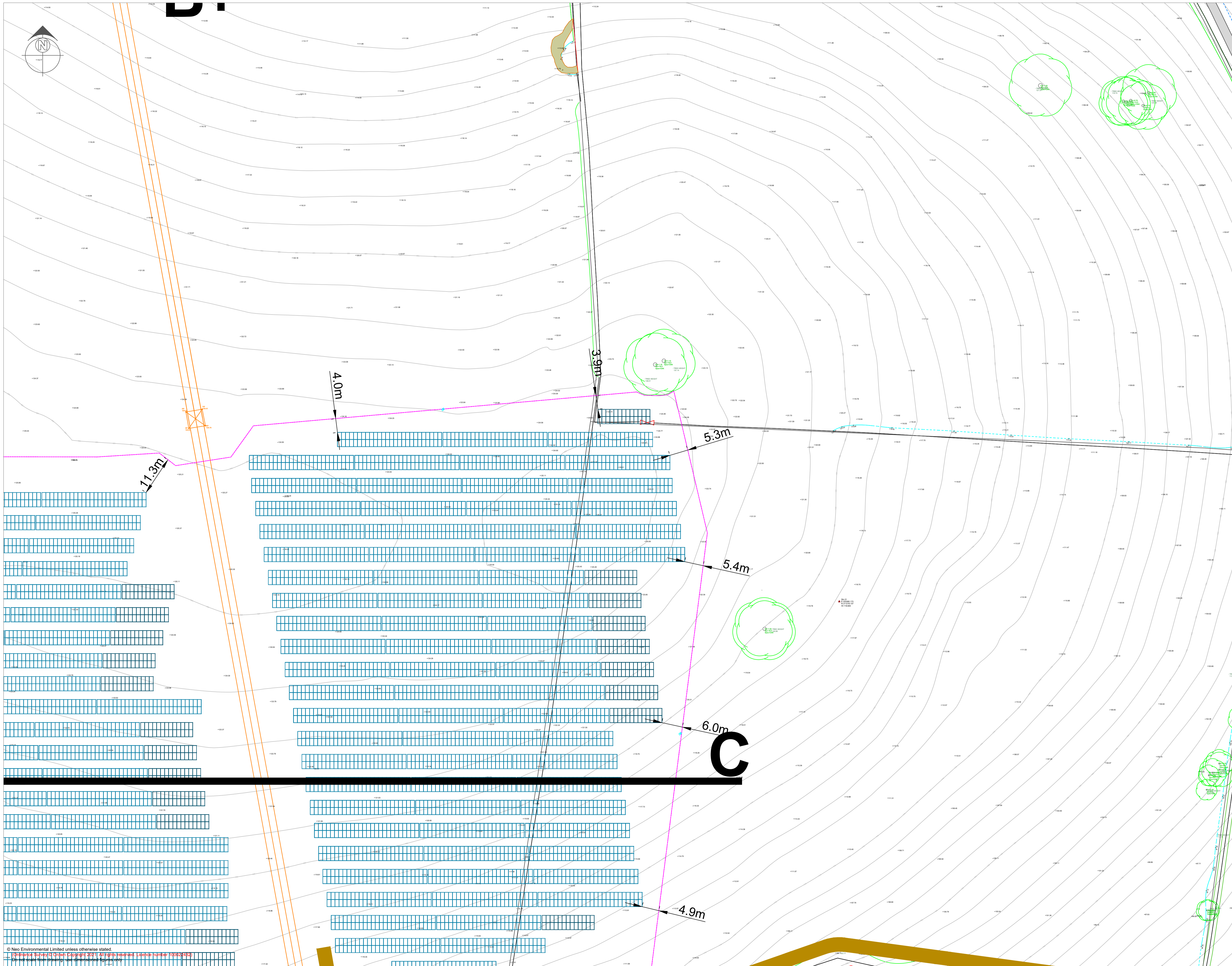

- Key**
- Development Boundary
 - Solar PV Array
 - Access Track
 - Security Fencing
 - Existing Vegetation

Drawn By: Jamie McGhee
 Address: Wright Business Centre
 1 Lonmay Road
 Glasgow
 G33 4EL

Ver.	Date	Comments

A 22/04/2021



Warrington Office: T: 01925 661 716 E: info@neo-environmental.co.uk

Glasgow Office: T: 0141 773 8262 E: info@neo-environmental.co.uk
 Naas Office: T: 00353 (0)45 844250 E: info@neo-environmental.ie
 Ballymena Office: T: 0282 565 0413 E: info@neo-environmental.co.uk

Project: Penpergwm Solar Farm
Client: Renewable Connection
Drawing: Indicative Infrastructure Layout (Sheet 6)

Project No.: NEO00668
Drawing No.: NEO00668_0621_A DRAFT
Drawn: JM **Checked:** MM **Approved:** PN

Scale: 1:500 @ A1 **Revision:**
Date: 22 April 2021 **A**

© Neo Environmental Limited unless otherwise stated.
 All Rights Reserved. Licence number 100029450

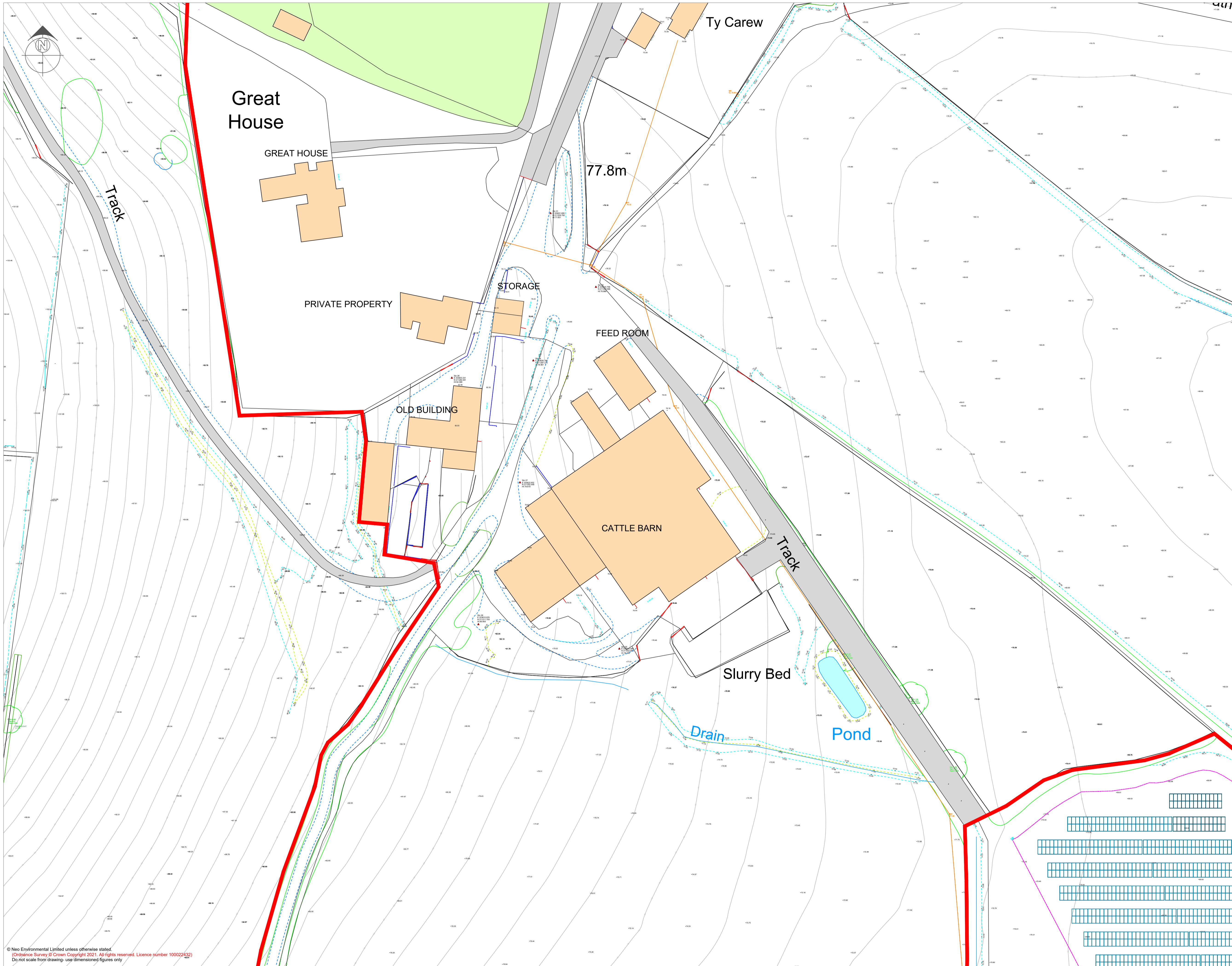

- Key**
- Development Boundary
 - Solar PV Array
 - Security Fencing
 - Ⓔ Existing Vegetation

Drawn By: Jamie McGhee
 Address: Wright Business Centre
 1 Lonmay Road
 Glasgow
 G33 4EL

Ver.	Date	Comments

A 22/04/2021



neo
 ENVIRONMENTAL

Warrington Office: T:01925 661 716 E: info@neo-environmental.co.uk

Glasgow Office: T: 0141 773 6262 E: info@neo-environmental.co.uk
 Naas Office: T:00353 (0)45 844250 E: info@neo-environmental.ie
 Ballymena Office: T:0282 565 0413 E: info@neo-environmental.co.uk

Project: Penpergwm Solar Farm
Client: Renewable Connection
Drawing: Indicative Infrastructure Layout (Sheet 7)

Project No.: NEO00668
Drawing No.: NEO00668_063I_A DRAFT
Drawn: JM **Checked:** MM **Approved:** PN
Scale: 1:500 @ A1 **Revision:**
Date: 22 April 2021 **A**

© Neo Environmental Limited unless otherwise stated.
 Ordnance Survey © Crown Copyright 2021. All rights reserved. Licence number 100029132
 Do not scale from drawing - use dimensioned figures only

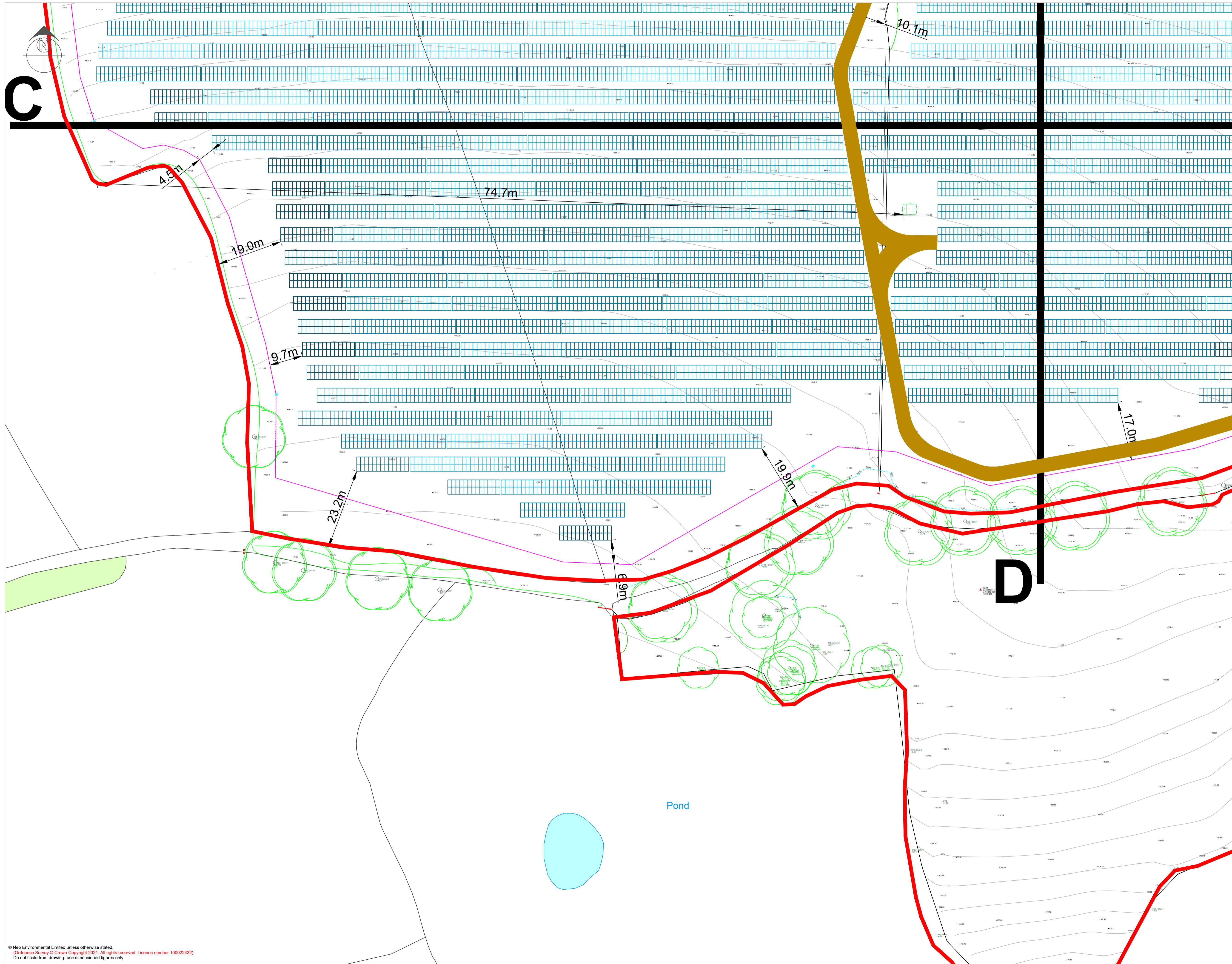

- Key**
- Development Boundary
 - Solar PV Array
 - Access Track
 - Transformer
 - Security Fencing
 - Existing Vegetation

Drawn By: Jamie McGhee
 Address: Wright Business Centre
 1 Lonmay Road
 Glasgow
 G33 4EL

Ver.	Date	Comments

A 22/04/2021



neo
 ENVIRONMENTAL

Warrington Office: T: 01925 661 716 E: info@neo-environmental.co.uk
 Glasgow Office: T: 0141 773 6262 E: info@neo-environmental.co.uk
 Naas Office: T: 00353 (0)45 844250 E: info@neo-environmental.ie
 Ballymena Office: T: 0282 565 0413 E: info@neo-environmental.co.uk

Project: Penpergwm Solar Farm
Client: Renewable Connection
Drawing: Indicative Infrastructure Layout (Sheet 8)

Project No.: NEO00668
Drawing No.: NEO00668_0641_A DRAFT
Drawn: JM **Checked:** MM **Approved:** PN

Scale: 1:500 @ A1 **Revision:**
Date: 22 April 2021 **A**

© Neo Environmental Limited unless otherwise stated.
 Ordnance Survey © Crown Copyright 2021. All rights reserved. Licence number 100022432
 Do not scale from drawing - use dimensioned figures only

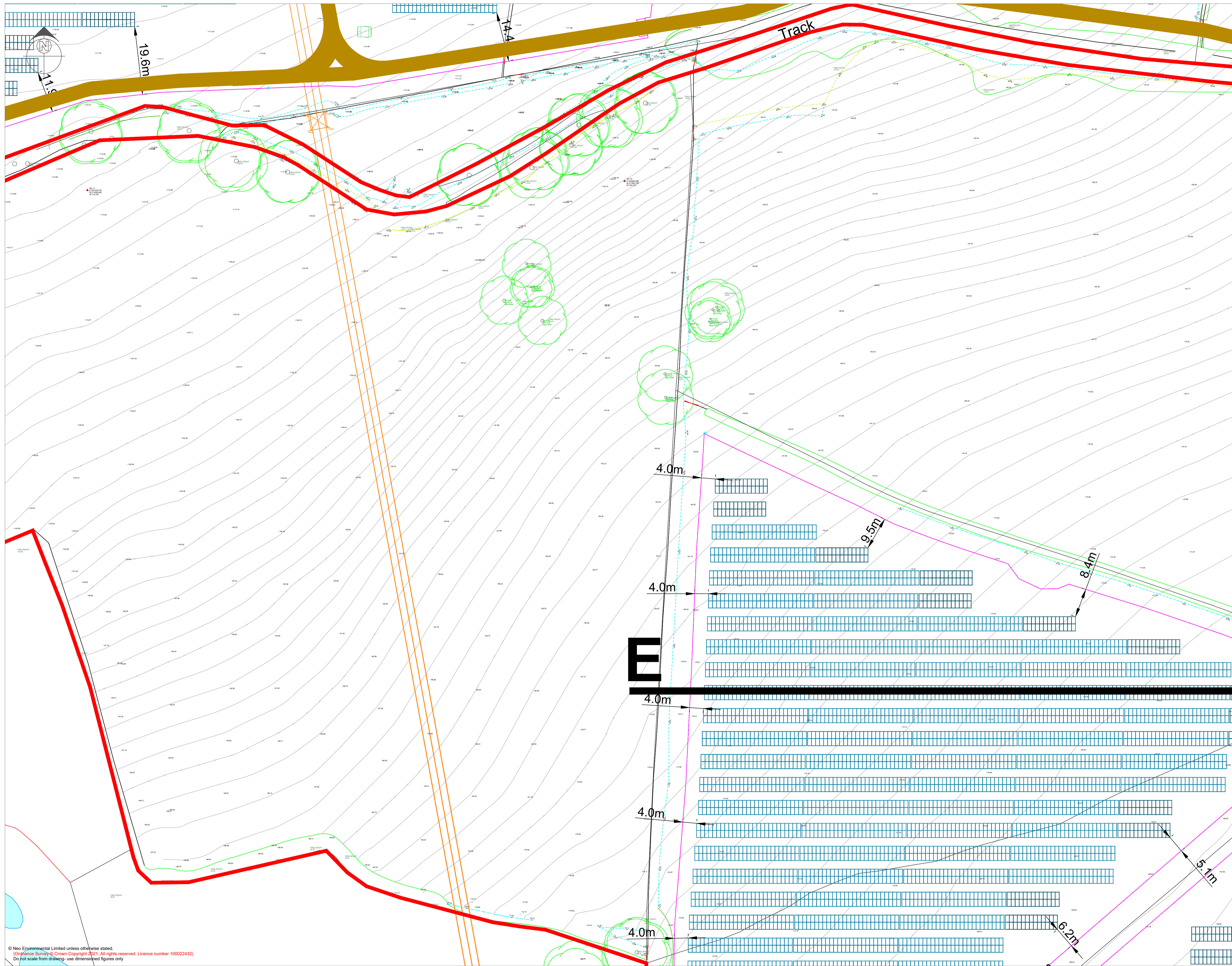

- Key**
- Development Boundary
 - Solar PV Array
 - Access Track
 - Transformer
 - Security Fencing
 - Existing Vegetation

Drawn By: Jamie McGhee
 Address: Wright Business Centre
 1 Lonmay Road
 Glasgow
 G33 4EL

Ver.	Date	Comments



Project: Penpergwm Solar Farm
Client: Renewable Connection
Drawing: Indicative Infrastructure Layout (Sheet 9)

Project No.: NEO00668
Drawing No.: NEO00668_065I_A DRAFT
Drawn: JM **Checked:** MM **Approved:** PN
Scale: 1:500 @ A1 **Revision:**
Date: 22 April 2021 **A**

© Neo Environmental Limited unless otherwise stated.
 (Ordnance Survey) Crown Copyright 2021. All rights reserved. Licence number 100022432
 Do not scale from drawing - use dimensioned figures only

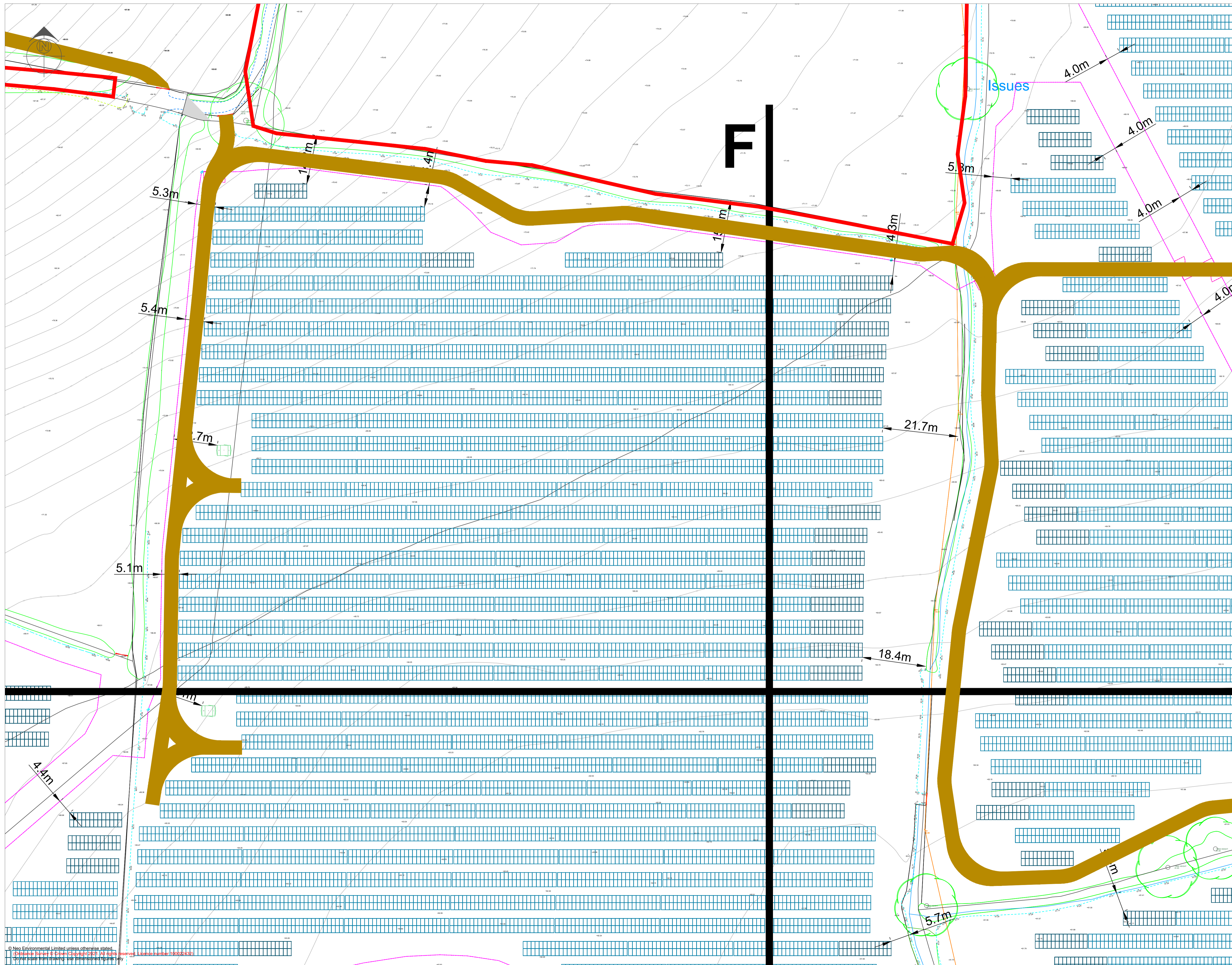

- Key**
- Development Boundary
 - Solar PV Array
 - Access Track
 - Transformer
 - Security Fencing
 - ⊗ Existing Vegetation

Drawn By: Jamie McGhee
 Address: Wright Business Centre
 1 Lonmay Road
 Glasgow
 G33 4EL

Ver.	Date	Comments



Project: Penpergwm Solar Farm
 Client: Renewable Connection
 Drawing: Indicative Infrastructure Layout (Sheet 10)

Project No.: NEO00668
 Drawing No.: NEO00668_0661_A DRAFT
 Drawn: JM Checked: MM Approved: PN

Scale: 1:500 @ A1 Revision:
 Date: 22 April 2021 A

© Neo Environmental Limited unless otherwise stated.
 All rights reserved. License number: 110002438.

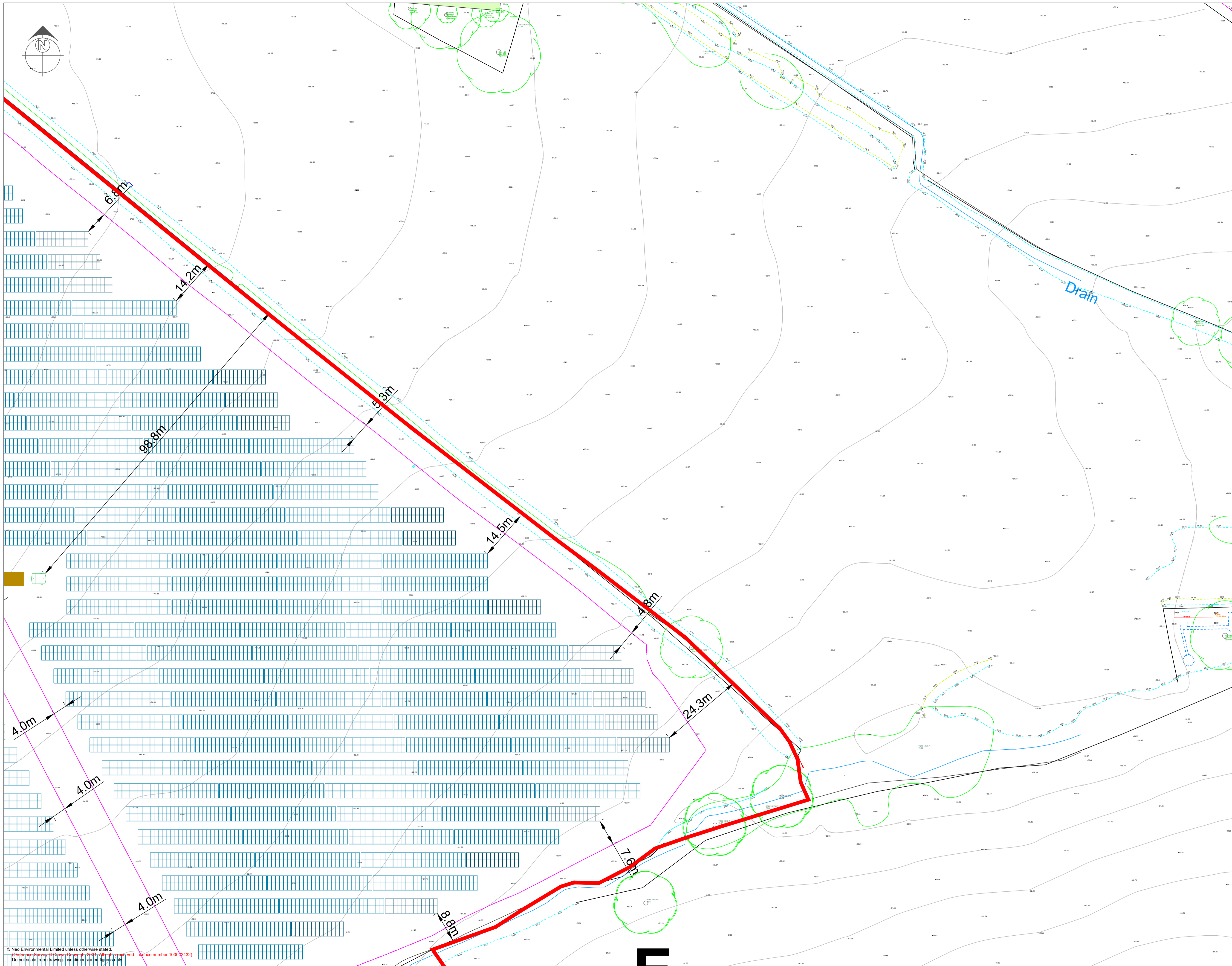

- Key**
- Development Boundary
 - Solar PV Array
 - Access Track
 - Transformer
 - Security Fencing
 - Existing Vegetation

Drawn By: Jamie McGhee
 Address: Wright Business Centre
 1 Lonmay Road
 Glasgow
 G33 4EL

Ver.	Date	Comments

A 22/04/2021



Warrington Office: T: 01925 661 716 E: info@neo-environmental.co.uk

Glasgow Office: T: 0141 773 6262 E: info@neo-environmental.co.uk
 Naas Office: T: 00353 (0)45 844250 E: info@neo-environmental.ie
 Ballymena Office: T: 0282 565 0413 E: info@neo-environmental.co.uk

Project: Penpergwm Solar Farm
Client: Renewable Connection
Drawing: Indicative Infrastructure Layout (Sheet 11)

Project No.: NEO00668
Drawing No.: NEO00668_0671_A DRAFT
Drawn: JM **Checked:** MM **Approved:** PN

Scale: 1:500 @ A1 **Revision:**
Date: 22 April 2021 **A**

© Neo Environmental Limited unless otherwise stated.
 All rights reserved. Licence number 10002432

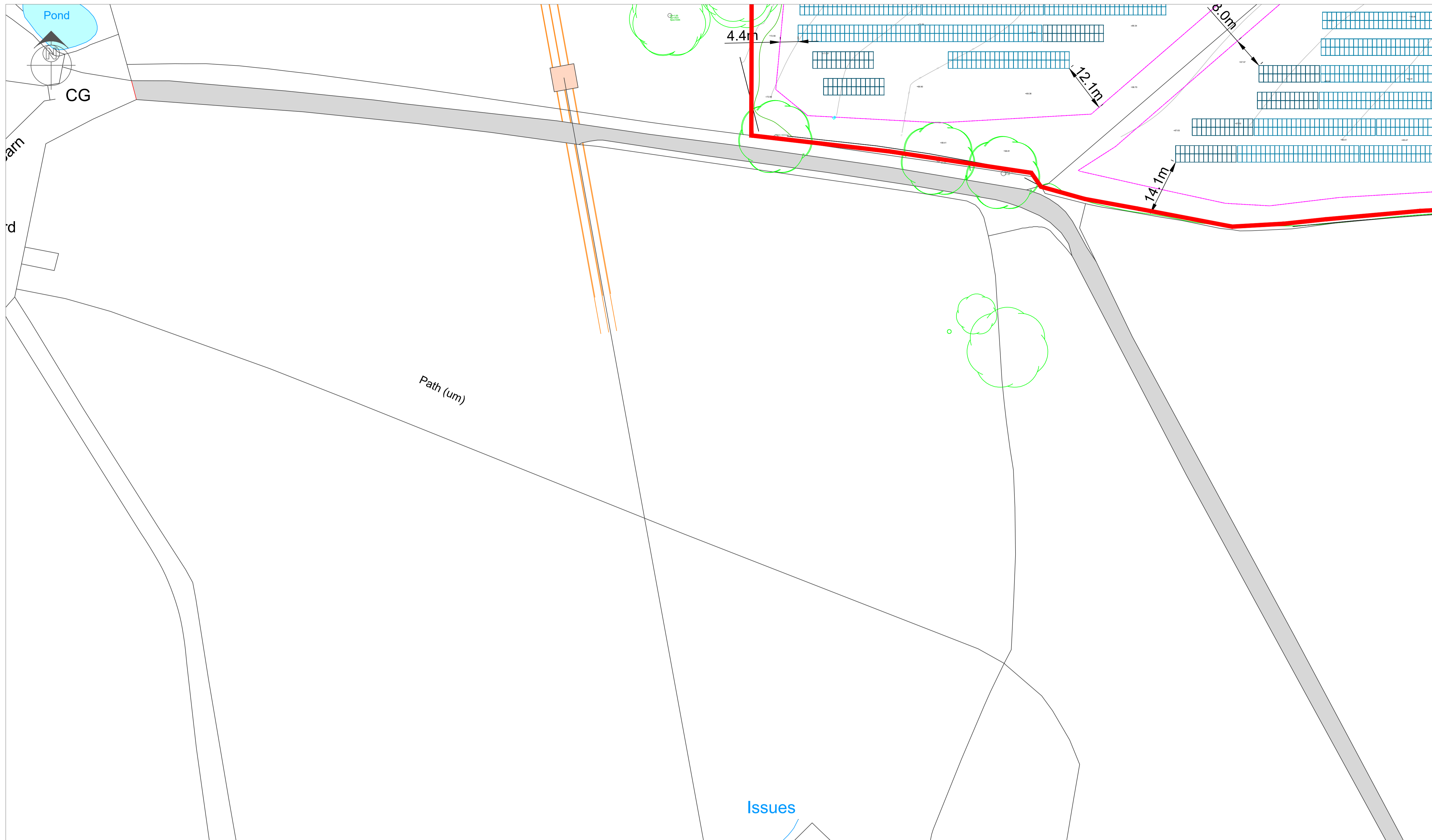

Key

- Development Boundary
- Solar PV Array
- Security Fencing
- Existing Vegetation

Drawn By: Jamie McGhee
 Address: Wright Business Centre
 1 Lonmay Road
 Glasgow
 G33 4EL

Ver.	Date	Comments

A 22/04/2021



Warrington Office: T:01925 661 716 E: info@neo-environmental.co.uk
 Glasgow Office: T: 0141 773 6262 E: info@neo-environmental.co.uk
 Naas Office: T:00353 (0)45 844250 E: info@neo-environmental.ie
 Ballymena Office: T:0282 565 0413 E: info@neo-environmental.co.uk

Project: Penpergwm Solar Farm
Client: Renewable Connection
Drawing: Indicative Infrastructure Layout (Sheet 12)

Project No.: NEO00668
Drawing No.: NEO00668_068I_A DRAFT
Drawn: JM **Checked:** MM **Approved:** PN

Scale: 1:500 @ A1 **Revision:**
Date: 22 April 2021 **A**

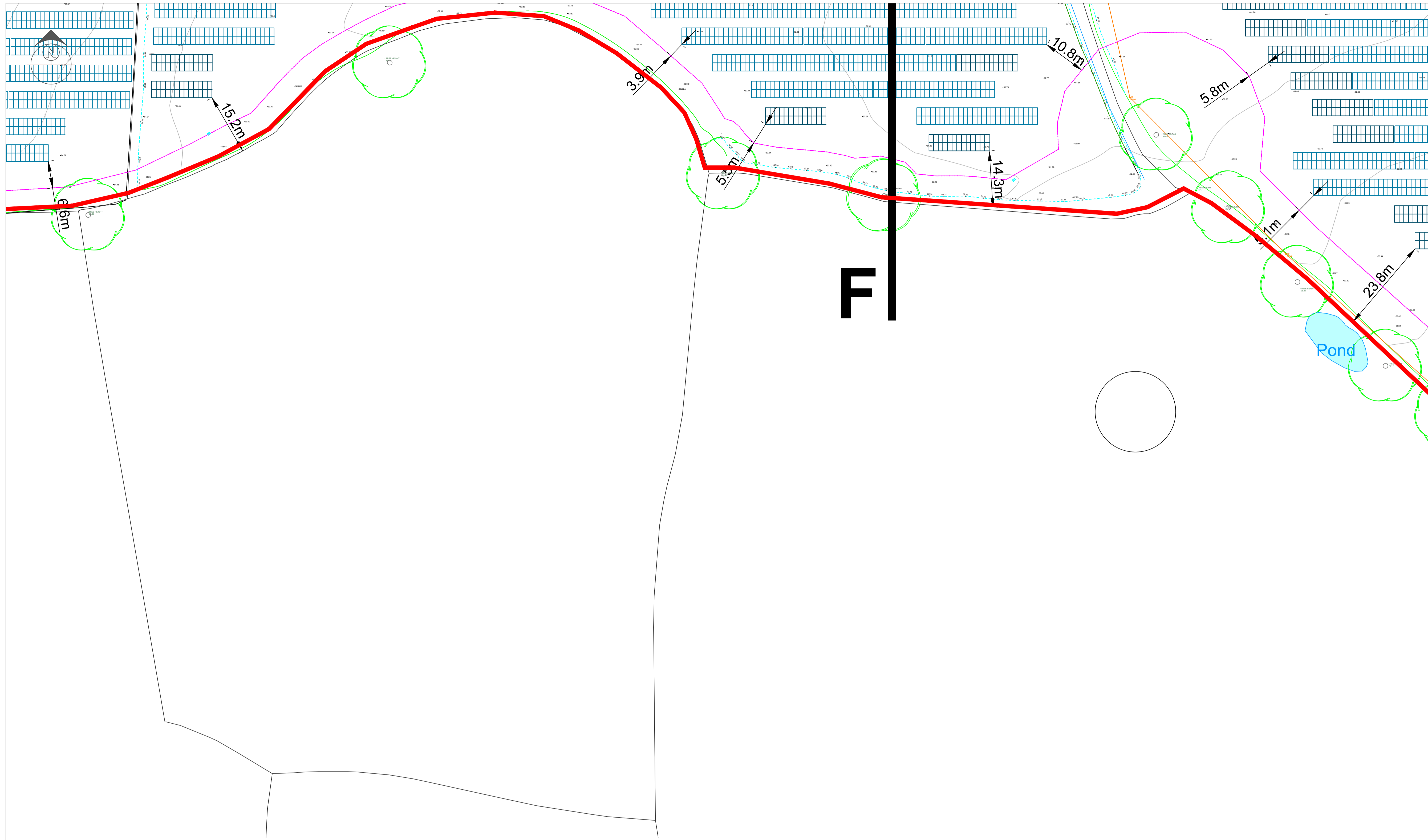

- Key**
- Development Boundary
 - Solar PV Array
 - Security Fencing
 - Existing Vegetation

Drawn By: Jamie McGhee
 Address: Wright Business Centre
 1 Lonmay Road
 Glasgow
 G33 4EL

Ver.	Date	Comments

A 22/04/2021



Warrington Office: T:01925 661 716 E: info@neo-environmental.co.uk
 Glasgow Office: T: 0141 773 6262 E: info@neo-environmental.co.uk
 Naas Office: T:00353 (0)45 844250 E: info@neo-environmental.ie
 Ballymena Office: T:0282 565 0413 E: info@neo-environmental.co.uk

Project: Penpergwm Solar Farm
Client: Renewable Connection
Drawing: Indicative Infrastructure Layout (Sheet 13)

Project No.: NEO00668
Drawing No.: NEO00668_069I_A DRAFT
Drawn: JM **Checked:** MM **Approved:** PN

Scale: 1:500 @ A1 **Revision:**
Date: 22 April 2021 **A**

© Neo Environmental Limited unless otherwise stated.
 Ordnance Survey © Crown Copyright 2021. All rights reserved. Licence number 100022432
 Do not scale from drawing - use dimensioned figures only



- Key**
- Development Boundary
 - Solar PV Array
 - Access Track
 - Construction Compound
 - Transformer
 - Security Fencing
 - ⊕ Existing Vegetation

Drawn By: Jamie McGhee
 Address: Wright Business Centre
 1 Lonmay Road
 Glasgow
 G33 4EL

Ver.	Date	Comments

A 22/04/2021



Warrington Office: T: 01925 661 716 E: info@neo-environmental.co.uk

Glasgow Office: T: 0141 773 6262 E: info@neo-environmental.co.uk
 Naas Office: T: 00353 (0)45 844250 E: info@neo-environmental.ie
 Ballymena Office: T: 0282 565 0413 E: info@neo-environmental.co.uk

Project: Penpergwm Solar Farm
Client: Renewable Connection
Drawing: Indicative Infrastructure Layout (Sheet 14)

Project No.: NEO00668
Drawing No.: NEO00668_070I_A DRAFT
Drawn: JM **Checked:** MM **Approved:** PN

Scale: 1:500 @ A1 **Revision:**
Date: 22 April 2021 **A**

© Neo Environmental Limited unless otherwise stated.
 Ordnance Survey © Crown Copyright 2021. All rights reserved. Licence number 100022432
 Do not scale from drawing - use dimensioned figures only



Key

 Development Boundary

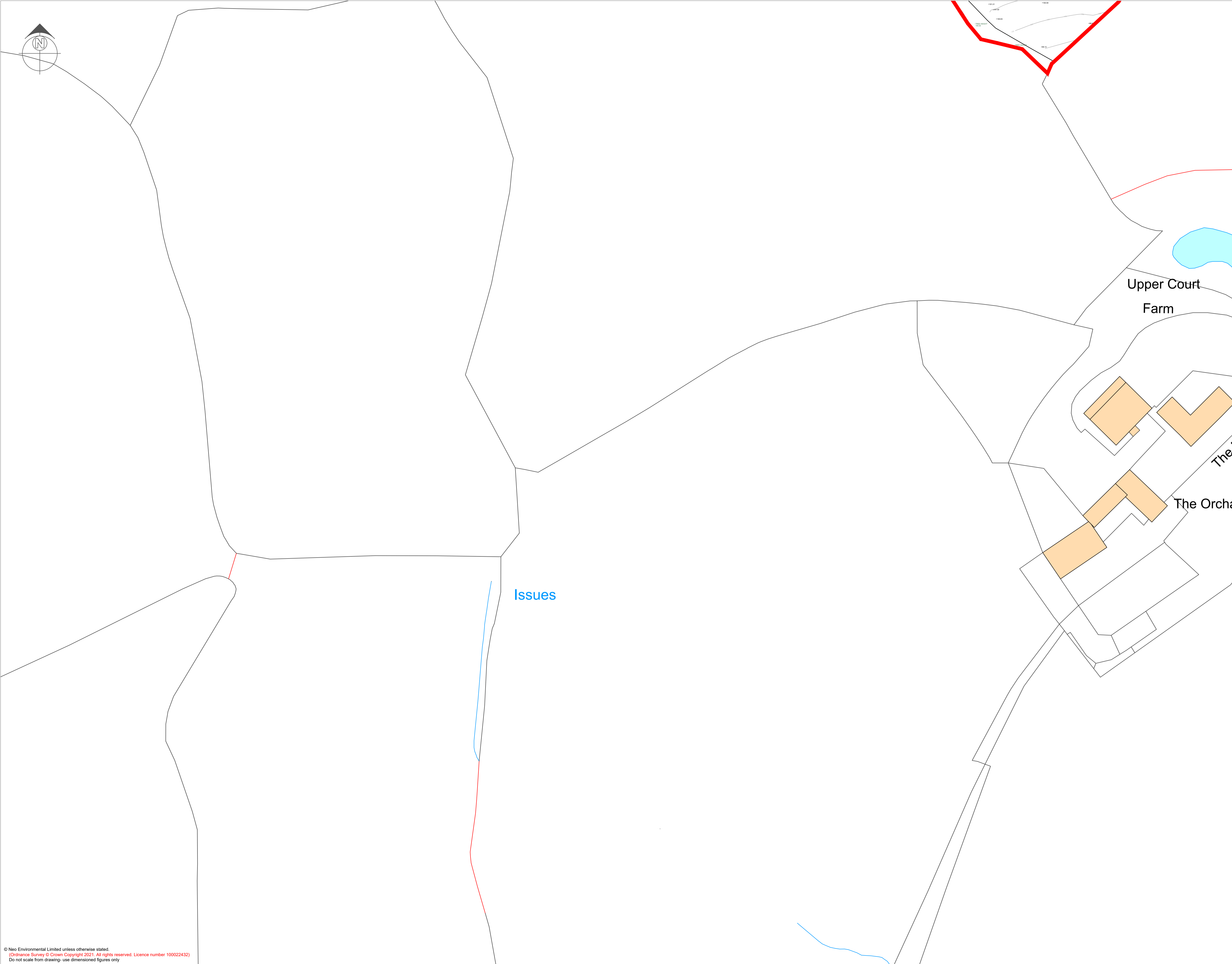

Upper Court
Farm

The Orcha

Issues

Drawn By: Jamie McGhee
Address: Wright Business Centre
1 Lonmay Road
Glasgow
G33 4EL

Ver.	Date	Comments

A 22/06/2021



neo
ENVIRONMENTAL

Warrington Office: T:01925 661 716 E: info@neo-environmental.co.uk

Glasgow Office: T: 0141 773 6262 E: info@neo-environmental.co.uk
 Naas Office: T:00353 (0)45 844250 E: info@neo-environmental.ie
 Ballymena Office: T:0282 565 0413 E: info@neo-environmental.co.uk

Project: Penpergwm Solar Farm
Client: Renewable Connection
Drawing: Indicative Infrastructure Layout (Sheet 15)

Project No.: NEO00668
Drawing No.: NEO00668_104I_A DRAFT
Drawn: JM **Checked:** MM **Approved:** PN

Scale: 1:500 @ A1 **Revision:**
Date: 23 June 2021 **A**